

A.S.P. Electro-Technology Ltd
INFORMATION SHEET

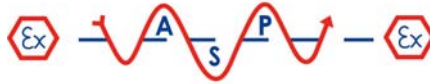

CONTROL UNITS - GP, JL & G2 Ranges
EExd and Weatherproof.



GP2S



G2S



JL4S



GPS

Introduction

This range of custom built control units can be used individually or combined to provide hazardous area systems for indoor or outdoor use. The enclosures can be fitted with a comprehensive range of components.

- | | | |
|--|---|--|
| <ul style="list-style-type: none"> • Isolators. • Relays. • Contactors. • Transformers. • MCBs. • Fuses. • Rotary Switches. • Printed Circuit Boards. • Invertors (fan cooled). • PLCs. • Meters. | <ul style="list-style-type: none"> • Indicators. • Pushbuttons. • Potentiometers. • RCDs (ELCBs). • Timers. • IS Components. • Clients' Products. • 19" Racks. • Fire & Gas Panels. • Zone 1 & Zone 2 use. • EExd. | <ul style="list-style-type: none"> • ATEX approved EX II 2G. • BASEEFA Certified. • CENELEC Approved. • IP65 & 66. • Variety of Enclosures. • Variety of Covers. • Cast Iron, Stainless Steel & Marine Grade Alloy. • Component Certified. • Full cover width viewing window now available. |
|--|---|--|



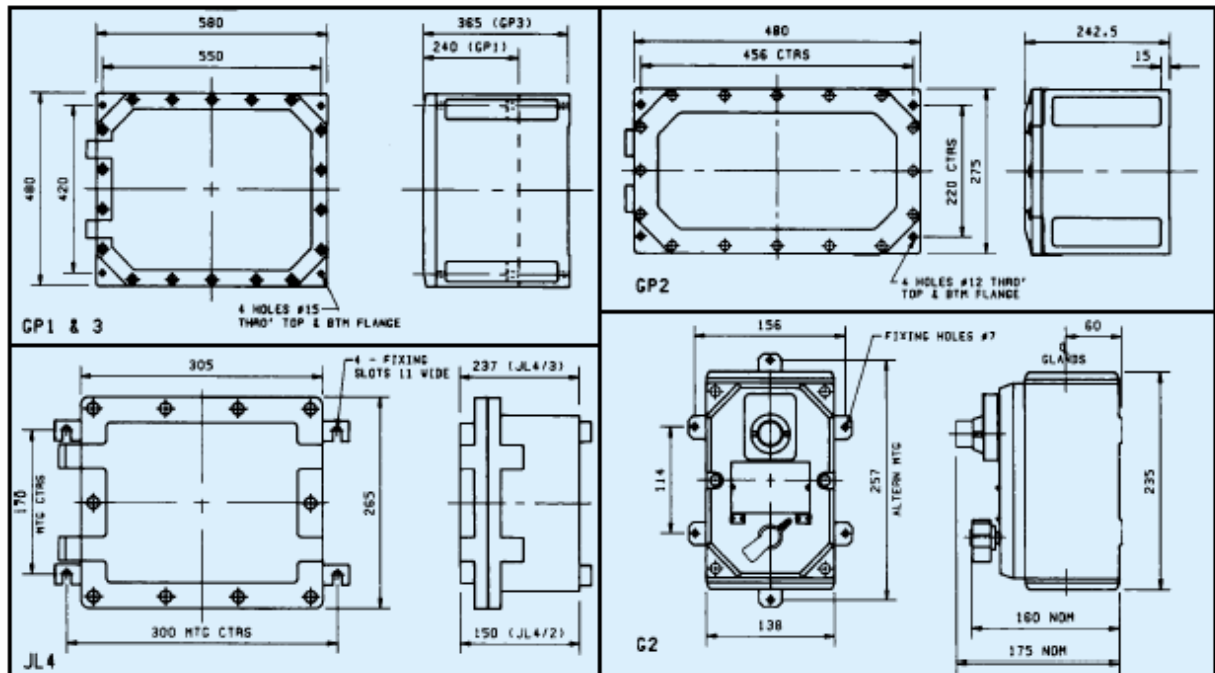
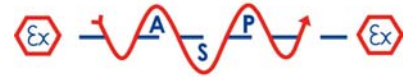

Specification

Isolators:	Up to 315 amp (AC1).
Rotary Switches:	Up to 12 with ratings of up to 660V, 32A, 4 pole, 6 pos.
Pushbutton:	Up to 24 with ratings up to 500V, 5A, 6 pole.
Potentiometers:	Up to 10W.
Circuit Breakers:	Up to 100 amp.
Meters:	Up to 6 mounted behind 70 or 100mm dia. windows. Ammeters up to 60A direct connected or via CT. Voltmeters up to 660V. Hours run and counters.
Indicators:	Up to 36 mounted behind Ø25mm windows. Multiple mounted behind Ø70mm, Ø100mm windows.
	Multiple mounted behind 300mm x 50mm window.
Fuses:	Up to 660V, 200A.
Contactors:	Up to 132kw (AC 3).
Earth Leakage:	Up to 200A.
Transformers:	Up to 3kVA.
Relays:	Up to 600V.
Timers:	Electrical, mechanical or electromechanical.
I.S. Equipment:	Please consult us with your requirements.
Printed circuit boards.	
19" rack equipment	Mounted behind 300mm x 50mm window.

PLCs.	
Invertors up to 7.5kw (fan cooled).	
Motor Starters and Distribution Units:	Please refer to separate data sheets.
Support Frames:	Units can be supplied on free standing frames if required.
Certification:	EExd IIB T4 & T6. ATEX approved. CENELEC EN 50014 & 18. Component approved enclosures simplify certification where clients wish to fit their own components into the enclosures.
Cable Entries:	16, 20, 25, 32, 40, 50, 63 or 75mm.
Ingress Protection:	IP65/66.
Ambient Temperature:	- GP1 & 3 = -40°C to +40°C/55°C. GP2 = -40°C to +40°C/55°C. JL4 = -55°C to +40°C/55°C. G2 = -55°C to +55°C.
Material:	Cast iron (GP1, 2 & 3, JL & G2). JL also in 316 stainless steel.
Finish:	Corrosion resistant epoxy paint.
Nominal Weights:	GP1 149Kg, GP3 182Kg, GP2 45Kg, JL 40Kg, G2 12Kg.

Supplied by:

A.S.P. Electro-Technology Ltd
Specialist Suppliers of Hazardous Area Certified
Electrical Products & Instrumentation

39 London Road, Hinckley, LE10 1HQ. U.K.
Tel: +44 (0)1455 635796 Fax: +44 (0)1455 251110
Email: sales@asp-electro-tech.com Web: asp-electro-tech.com



This publication is not intended to form the basis of a contract. All the above specifications, dimensions, weights, tolerances etc are typical and may be varied or changed by the manufacturer without prior notice. A.S.P. Electro-Technology accept no liability for consequence of use.