

# A.S.P. Electro-Technology Ltd

## INFORMATION SHEET

### 7 Series Emergency Fluorescent Luminaires

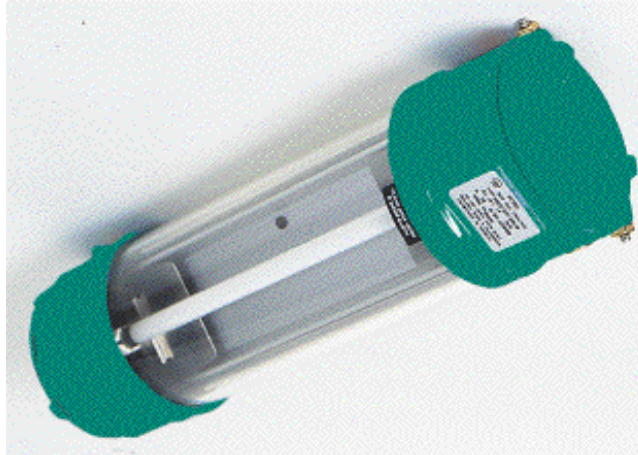

#### Features

- ✦ Lightweight, slimline and compact construction
- ✦ Polycarbonate, glass, lacquered polycarbonate overtube to suit most hazardous areas
- ✦ Tested to meet ATEX requirements (compulsory standard from 2003)
- ✦ Vibration resistant option for shipboard applications
- ✦ 4 hour minimum battery life option (standard internal batteries-cooler, longer life, voltage options, etc)

#### Certification & Approval

Certification Code: EEx d IIB & IIC T5-T6  
Certification Standard: EN50014-018  
Certificate Number: SIRA Ex 97D1098 (ATEX pending)  
Degree of Protection: IP 66 to IEC 529

Size	Model	A	B	All dimensions in mm
1	8w	335	448	
2	18w	632	752	
4	36w	1242	1362	
5	58w	1542	1662	

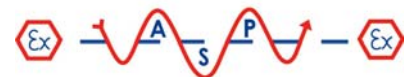

Supplied by: A.S.P. Electro-Technology Ltd  
Tel: +44 (0)1455 635796 Fax: +44 (0)1455 251110  
Email: [sales@asp-electro-tech.com](mailto:sales@asp-electro-tech.com). [www.asp-electro-tech.com](http://www.asp-electro-tech.com)

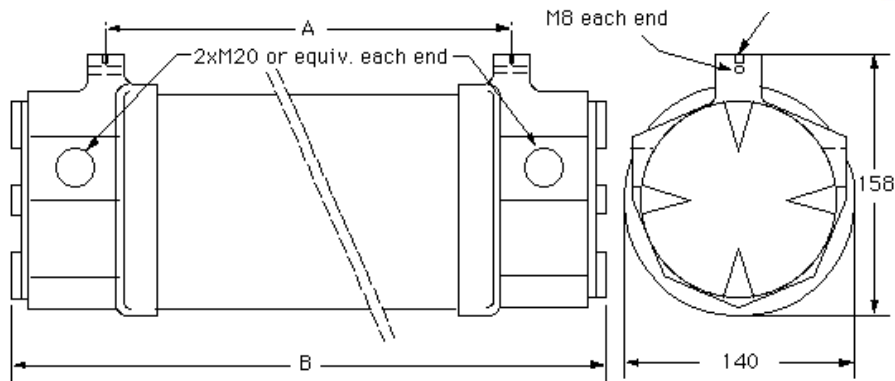
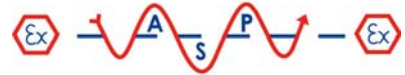

## Technical Data

Model range	<ul style="list-style-type: none"> <li>Emergency luminaire - single &amp; twin 8w, 18w, 36w, 58w.</li> <li>Compact Fluorescents - details on application.</li> </ul>															
Supply voltage	<ul style="list-style-type: none"> <li>Switch start 240v, 50Hz as standard.</li> <li>Electronic ballast 220-250v, 50/60Hz or rapid/vivatronic start.</li> <li>Other voltages &amp; frequencies on request, including 110v, 50 or 60Hz options &amp; DC central battery applications.</li> </ul>															
Control gear	<ul style="list-style-type: none"> <li>Integral including batteries, charger/inverter and ballast.</li> <li>Operating power factor on request.</li> </ul>															
Certification data	<p>All options certified for -25°C.</p> <p>8w T6 @ Ta=40°C T4 @ Ta=52°C EEx d IIC glass or polycarbonate.</p> <p>18w T6 @ Ta=40°C T5 @ Ta=55°C EEx d IIC glass or polycarbonate.</p> <p>36w T6 @ Ta=40°C T5 @ Ta=55°C EEx d IIB glass or polycarbonate.</p> <p>58w T6 @ Ta=40°C T5 @ Ta=55°C EEx d IIB glass or polycarbonate.</p>															
Lamp source options	13mm T5 (8w), 26mm T8 (all others) or PL as option. Removable lamp assembly. Lamps included only in 8w luminaires.															
Mounting facilities	2 x M8 tapped holes - vertical and horizontal - at each end.															
Cable entries	2 x M 20 - ISO (1 plugged) each end. Other thread forms on request.															
Terminals	3 wire and earth. Cable size 4 mm <sup>2</sup> max with looping.															
Finish	2 pack aqua epoxy paint on pre-treated and primed surface.															
Material	Corrosion resistant anodised light alloy body and covers with polycarbonate or glass overtube. 70w polycarbonate only.															
Protective guards	An overhead canopy and/or wire guard are available on request.															
Weight	<table border="0"> <tr> <td></td> <td>Single</td> <td></td> <td>Twin</td> <td></td> </tr> <tr> <td></td> <td>Polycarbonate</td> <td>Glass</td> <td>Polycarbonate</td> <td>Glass</td> </tr> <tr> <td></td> <td>4.5kg</td> <td>5.8kg</td> <td>5.0kg</td> <td>6.3kg</td> </tr> </table>		Single		Twin			Polycarbonate	Glass	Polycarbonate	Glass		4.5kg	5.8kg	5.0kg	6.3kg
	Single		Twin													
	Polycarbonate	Glass	Polycarbonate	Glass												
	4.5kg	5.8kg	5.0kg	6.3kg												



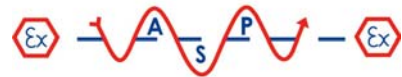

6.5kg	9.1kg	7.0kg	9.6kg
10kg	15.2k	10.5kg	15.7kg
12kg	18.5kg	12.5kg	19.0kg

Mounting accessories	Various mounting accessories available.
Other options	Special vibration resistant base mounted lamp version for use on board ships etc; addressable control; photocell device; in-line fuse protection, through wiring (for 18w only).

## How To Order

Product codes for emergencies are formed as follows:

Series Ref.	No. of tubes	Power (watts)	Size (Fitting length in feet)	Voltage	Frequency
7	1 or 2	e.g. 36	e.g. 4 (ft)	e.g. 240	e.g. 50

and written: 7236 / S4 / 240 / 50 / EM

N.B. 18w, 36w & 58w are supplied switch maintained as normal, with both tubes on mains power and 1 tube on the internal battery supply in the event of power failure.

## Special features

specified using the following codes:

/TW	Through wiring(18w option only)
/GL	Glass body for solvent/paint areas
/LP	Lacquered polycarbonate body for solvent/ paint areas
/HF	High frequency ballast
/R	Rapid start
/Pg	Pg 13.5 cable entries
/WG	Wire Guard
/SC	Sun canopy
/CF	Compact fluorescent
/PC	Pole clamp
/PM	Pendant mounting
/B	Vibration resistant base mounted lamps (Twins only)
/EM	Maintained Emergency (18w, 36w & 58w)
/EM/NM	Non maintained single - 8w
/EM/M	Maintained single - 8w
/EM/S	Sustained - 8w

These are added to the product codes as required: e.g. 7236 / S4 / 240 / 50 / EM or 7108 / S1 / 220 / 60 / EM / S / B

## Supplied by:

**A.S.P. Electro-Technology Ltd**

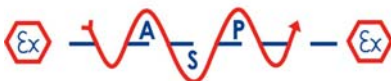

39 London Road, Hinckley, LE10 1HQ. U.K.  
Tel: +44 (0)1455 635796 Fax: +44 (0)1455 251110  
Email: [sales@asp-electro-tech.com](mailto:sales@asp-electro-tech.com)  
Web: [asp-electro-tech.com](http://asp-electro-tech.com)

*This publication is not intended to form the basis of a contract. All the above specifications, dimensions, weights, tolerances etc are typical and may be varied or changed by the manufacturer without prior notice. A.S.P. Electro-Technology accept no liability for consequence of use.*